

**FOR LEASE**

5,145 SF | Corona, CA | High-Image Office Suite

Presented by Strata Realty, Inc. | [www.stratarealty.com](http://www.stratarealty.com) | T (951) 280-1733 | F (951) 280-1739



## 5,145 SF HIGH-IMAGE OFFICE SUITE

### Location

1861 California Avenue, Suite 101  
Corona, CA 92881

### Features

- Part of a 10 acre master-planned office park
- Highly upgraded tenant improvements, plug and play space-ready for occupancy
- Dramatic reception area
- Herculite glass conference room doors
- Two (2) private offices
- Two (2) conference rooms
- Break room with sink, cabinets, and disposals
- Copy and fax center
- Men's and Women's restrooms
- 4:1 Parking
- Directly across from the South Corona post office and within walking distance to many retail amenities nearby
- Great access to 91 and I-15 freeways



### Contact:

#### Timothy Hawke, SIOR

(951) 280-1733 | [thawke@stratarealty.com](mailto:thawke@stratarealty.com)

#### Adam Silverman

(951) 280-1733 | [asilverman@stratarealty.com](mailto:asilverman@stratarealty.com)

#### Jason Palda

(951) 280-1733 | [jpalda@stratarealty.com](mailto:jpalda@stratarealty.com)

**FOR LEASE**

5,145 SF | Corona, CA | High-Image Office Suite

Contact: Tim Hawke, Adam Silverman, or Jason Palda | T (951) 280-1733

**FLOOR PLAN**

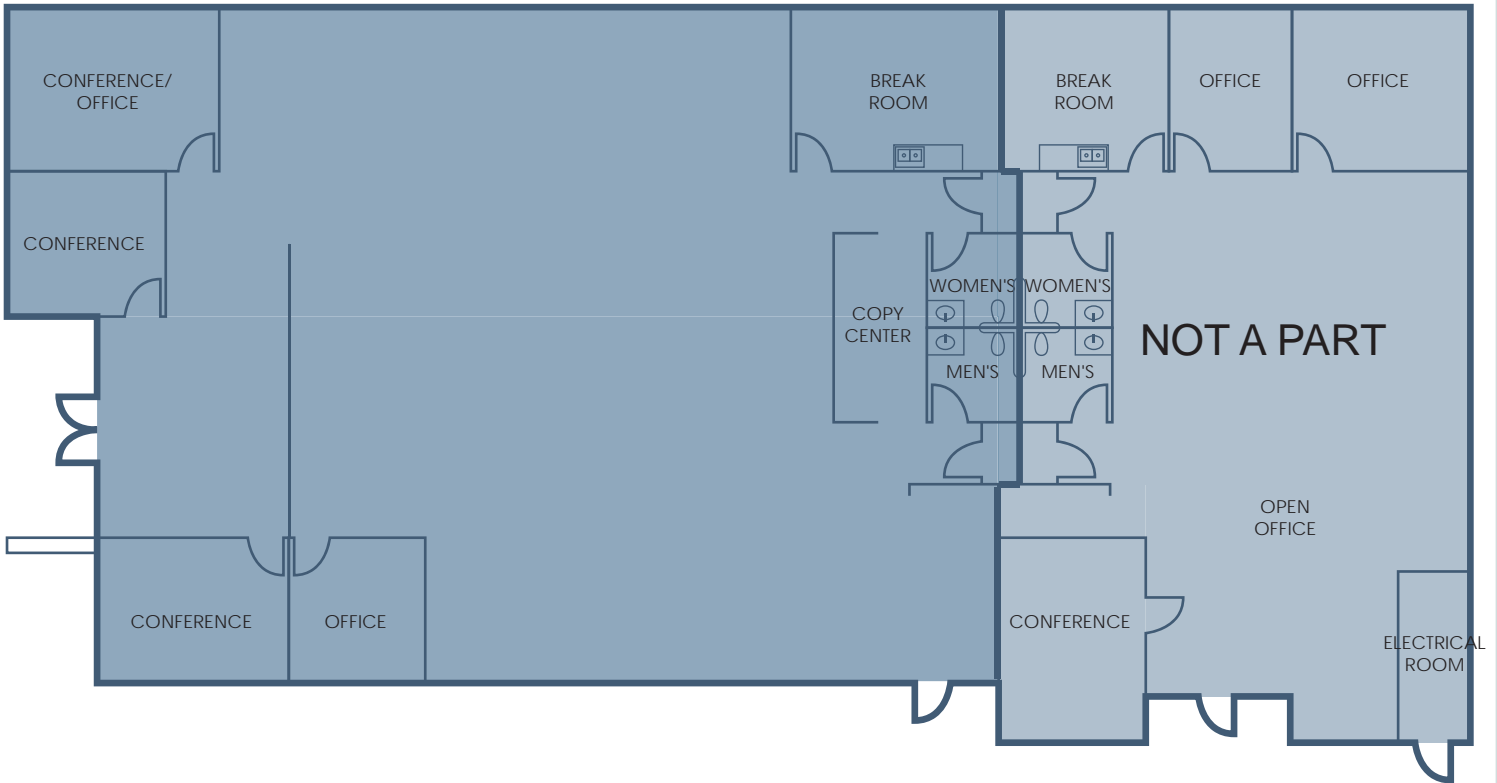

**SITE PLAN**



**DRE Information**